

Log in or register to create Field Kits and Sales Worksheets. [Why register?](#) [Log In](#)

[Register](#)

Building America Solution Center

EERE » BTO » Building America » Solution Center » Guides

Footing Drain Pipe

[Feedback](#)

[Print this page](#)

[PDF version](#)

Scope

Description

Success

Climate

Training

CAD

Compliance

Retrofit

More

Sales

Scope

Install drain tile (perforated plastic drainage pipe) along the exterior (or interior) of the footings of basement and crawlspace walls to provide drainage around the foundations.

- Install drain pipe to sit outside of, not on top of, the footings and below the bottom of the concrete slab or crawlspace floor.
- Lay the pipe with enough slope to drain to a non-perforated pipe that carries the collected water to daylight, to a drywell, to a storm sewer if approved by the local municipality, or to a sump pump that will transport it to daylight, a storm sewer, or a drywell.

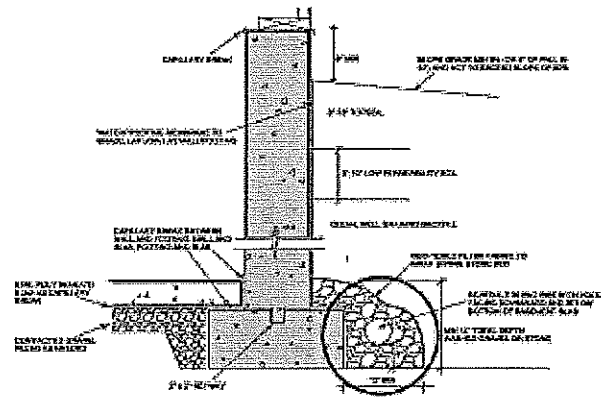

Footing drain pipe is located exterior of the footings below the slab and is surrounded by washed stone and filter fabric.

- Lay the drain pipe, perforations down, in a gravel trench with at least 6 inches of ½-inch to ¾-inch washed gravel or stone above the pipe and at least 2 inches below ([IRC 2009](#)).
- Install landscape fabric under, around, and over the washed gravel ([IRC 2009](#), [ENERGY STAR 2015](#)).
- Alternately, use drain pipe encased in a filter-fabric sock and surround the cloth-covered pipe with gravel. Or, install a code-approved composite foundation drainage system (CFDS) ([IRC 2009](#), [ENERGY STAR 2015](#)).

According to the [International Residential Code](#) and ENERGY STAR Certified Homes, drain tile is not required when a certified hydrologist, soil scientist, or engineer has determined that a foundation is installed in well-drained ground or sand-gravel mixture soils, as identified in the [2009 IRC](#), Table R405.1.

See the [Compliance Tab](#) for related codes and standards requirements, and criteria to meet national programs such as DOE's Zero Energy Ready Home program, ENERGY STAR Certified Homes, and Indoor airPLUS.

Last Updated: 12/20/2017

MOBILE FIELD KIT

The Building America Field Kit allows you to save items to your profile for review or use on-site.

[Sign Up](#) or [Log In](#)

